

# ESDBL...P Series

## Transient Voltage Suppressors

for ESD Protection

### Features

- Low Leakage Current
- Bi-direction high reliability

### PINNING

PIN	DESCRIPTION
1	Anode
2	Anode

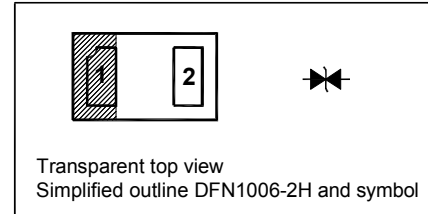

### Absolute Maximum Ratings ( $T_a = 25^\circ\text{C}$ )

Parameter	Symbol	Value	Unit
IEC61000-4-2 (ESD) Air Contact	$V_{\text{ESD}}$	$\pm 15$ $\pm 8$	KV
Peak Pulse Power On FR-5 Board <sup>1)</sup>	$P_D$	300	mW
Thermal Resistance Junction to Ambient Air	$R_{\theta\text{JA}}$	400	$^\circ\text{C}/\text{W}$
Junction Temperature	$T_j$	- 55 to + 150	$^\circ\text{C}$
Storage Temperature Range	$T_{\text{stg}}$	- 55 to + 150	$^\circ\text{C}$

<sup>1)</sup>FR-5 = 1.0 X 0.75 X 0.62 in .

### Characteristics at $T_a = 25^\circ\text{C}$

Type	Marking Code	Reverse Stand-off Voltage	Reverse Current	Breakdown Voltage			Clamping Voltage	Reverse Peak Pulse Current	Capacitance		
		$V_{\text{RWM}}$	$I_{\text{R}}$ at $V_{\text{RWM}}$	$V_{\text{BR}}$		at $I_{\text{T}}$	$V_{\text{C}}$ at $I_{\text{PP}}$	$I_{\text{PP}}$	$C_j$	at f	at $V_{\text{R}}$
		Max. (V)	Max. ( $\mu\text{A}$ )	Min. (V)	Max. (V)	(mA)	Max. (V)	(A)	Typ. (pF)	(MHz)	(V)
ESDBL3V3P	C	3.3	1	5	7	1	10.5	1	15	1	0
ESDBL5V0P	E	5	1	5.8	7.8	1	12.5	1	15	1	0

**TOP DYNAMIC**



Dated: 08/06/2013 Rev: 02

# ESDBL...P Series

## PACKAGE OUTLINE

Plastic surface mounted package

DFN1006-2H

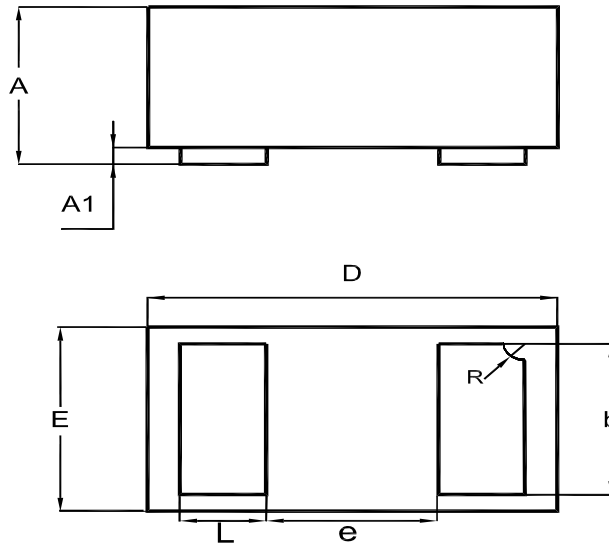

UNIT	A	A1	b	D	E	e	L	R
mm	0.51 0.46	0.05 0	0.55 0.45	1.05 0.95	0.65 0.55	0.4	0.3 0.2	0.15 0.05

## Recommended Soldering Footprint

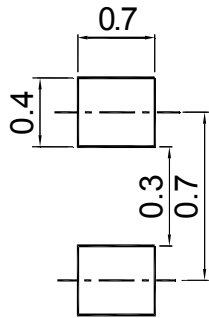

## Packing information

Package	Tape Width (mm)	Pitch		Reel Size		Per Reel Packing Quantity
		mm	inch	mm	inch	
DFN1006-2H	8	4 ± 0.1	0.157 ± 0.004	178	7	5,000

**TOP DYNAMIC**



Dated: 08/06/2013 Rev: 02