

# ES1AW THRU ES1JW

## Surface Mount Superfast Recovery Rectifier

Reverse Voltage – 50 to 600 V

Forward Current – 1 A

### Features

- Easy pick and place
- For surface mounted applications
- Low profile package
- Superfast recovery times for high efficiency

### PINNING

PIN	DESCRIPTION
1	Cathode
2	Anode

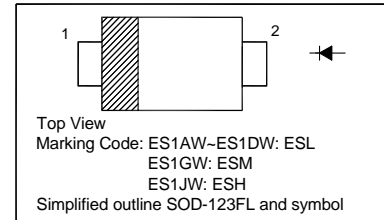

### Absolute Maximum Ratings and Characteristics

Ratings at 25°C ambient temperature unless otherwise specified. Single phase, half wave, 60 Hz, resistive or inductive load.

For capacitive load, derate current by 20%.

Parameter	Symbols	ES1AW	ES1BW	ES1DW	ES1GW	ES1JW	Units
Maximum Recurrent Peak Reverse Voltage	$V_{RRM}$	50	100	200	400	600	V
Maximum RMS Voltage	$V_{RMS}$	35	70	140	280	420	V
Maximum DC Blocking Voltage	$V_{DC}$	50	100	200	400	600	V
Maximum Average Forward Rectified Current $T_L=100^\circ\text{C}$	$I_{F(AV)}$	1					A
Peak Forward Surge Current 8.3 ms Single Half Sine Wave Superimposed on Rated Load (JEDEC Method)	$I_{FSM}$	30					A
Maximum Forward Voltage at 1 A	$V_F$	0.95		1.3		1.7	V
Maximum Reverse Current at $T_A=25^\circ\text{C}$ at Rated DC Blocking Voltage at $T_A=100^\circ\text{C}$	$I_R$	5 100					$\mu\text{A}$
Typical Junction Capacitance at $V_R=4\text{ V}$ , $f=1\text{ MHz}$	$C_J$	10					pF
Maximum Reverse Recovery Time at $I_F=0.5\text{ A}$ , $I_R=1\text{ A}$ , $I_{rr}=0.25\text{ A}$	$t_{rr}$	35					ns
Operating Junction and Storage Temperature Range	$T_j, T_{stg}$	- 55 to + 150					$^\circ\text{C}$

**TOP DYNAMIC**



Dated: 10/09/2015 Rev: 01

# ES1AW THRU ES1JW

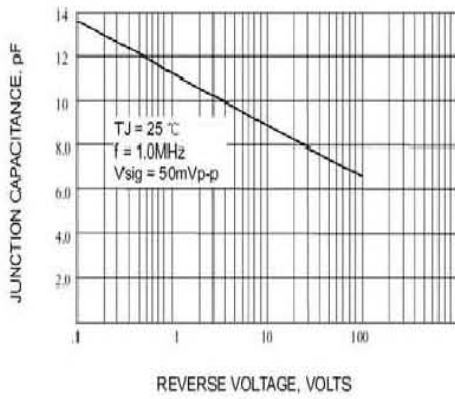

Fig. 1- TYPICAL JUNCTION CAPACITANCE

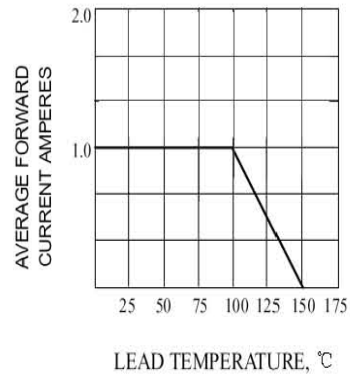

Fig. 2-MAXIMUM AVERAGE FORWARD CURRENT RATING

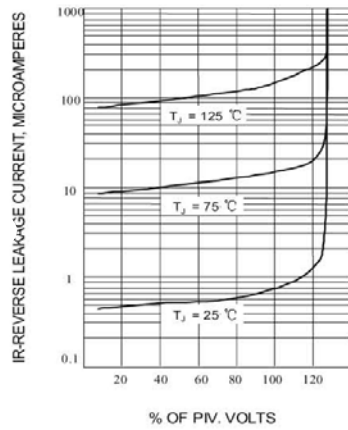

Fig. 3-TYPICAL REVERSE CHARACTERISTICS

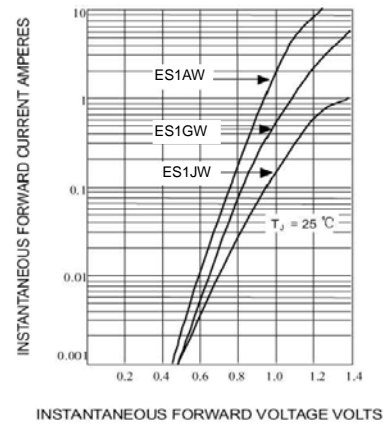

Fig. 4-TYPICAL FORWARD CHARACTERISTICS

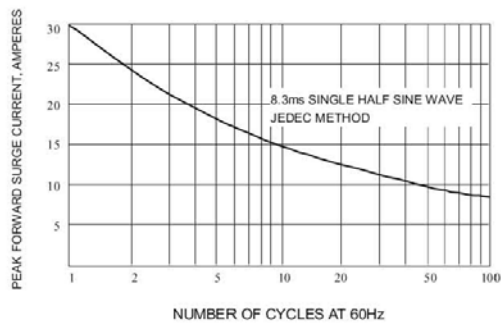

Fig. 5-MAXIMUM NON-REPETITIVE SURGE CURRENT

**TOP DYNAMIC**



Dated: 10/09/2015 Rev: 01

# ES1AW THRU ES1JW

## PACKAGE OUTLINE

Plastic surface mounted package; 2 leads

SOD-123FL

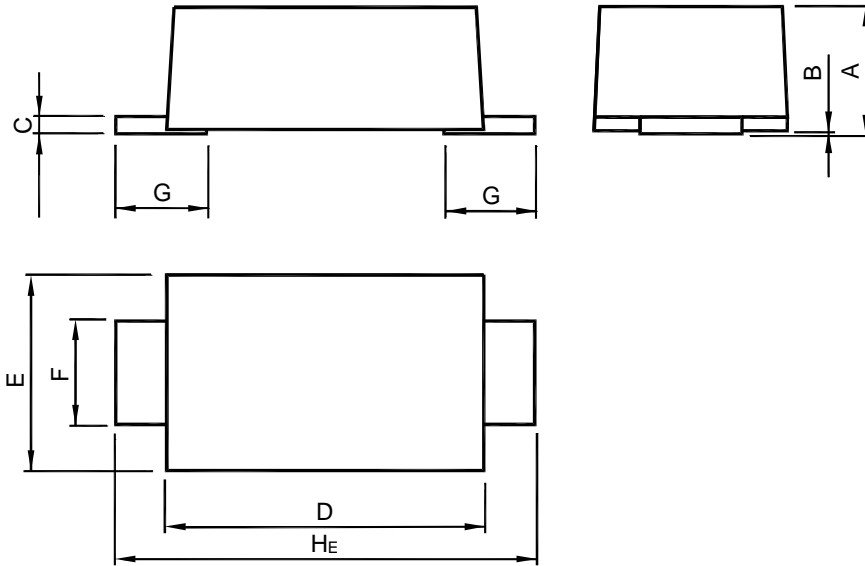

UNIT	A	B	C	D	E	F	G	H <sub>E</sub>
mm	1.08	0.1	0.2	2.9	1.9	1.1	0.9	3.9
	0.88	0	0.1	2.6	1.7	0.8	0.7	3.5

## Recommended Soldering Footprint

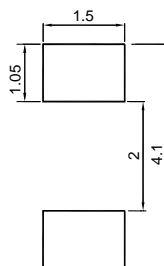

## Packing information

Package	Tape Width (mm)	Pitch		Reel Size		Per Reel Packing Quantity
		mm	inch	mm	inch	
SOD-123FL	8	4 ± 0.1	0.157 ± 0.004	178	7	3,000

**TOP DYNAMIC**



Dated: 10/09/2015 Rev: 01